



Cleats for Sports Netting

Leading Sports Net manufacturers are using Clamcleat® rope cleats for tensioning nets and headlines.

- In ski resorts, barrier nets are used to keep spectators away from the piste when watching ski racers. Both the CL223 and CL234 are used to tension snow netting.

- The CL211 Mk2 is used as a net tensioner on this beach volleyball set.

- The CL223 is ideal for tensioning both volley ball and badminton nets. Use the CL260 for tensioning lightweight, portable nets.

Where a wall rack replaces posts - the picture shows CL213 Fine Line cleats, but for heavier duty nets, the CL254 alloy Midi is used, with larger ropes. The CL204 and CL217 Mk1 are also used on wall racks.



These four cleats are used to tension nets on wall racks.



Cleats used to tension snow netting



CL234



CL223

The CL234 is rigged like this

The CL223 is rigged like this

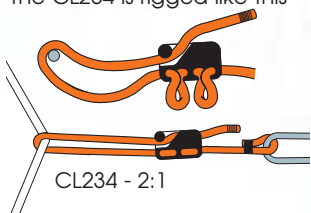

CL234 - 2:1

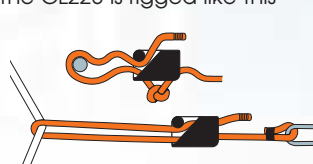

CL223 - 2:1

CL211Mk2  This cleat is used to tension the net in this beach volleyball set.



Cleat to tension volleyball nets, badminton nets and lightweight, portable nets (CL260).



CL223



CL260

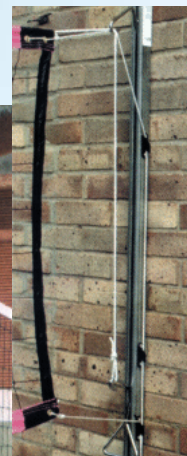

Rope size and Cleats

1/16" - 3/16" (2 - 5mm) Ø	CL260	
1/8" - 1/4" (3 - 6mm) Ø	CL204, CL211 Mk2, CL213, CL217 Mk1, CL223	
3/16" - 5/16" (4 - 8mm) Ø	CL254	
1/4" - 1/2" (6 - 12mm) Ø	CL234	

Clamcleats Limited Watchmead Welwyn Garden City Hertfordshire AL7 1AP England
 Telephone 01707 330101 Fax 01707 321269 e-mail sales@clamcleat.com
www.clamcleat.com

Schiffsausrüster

TOPLICHT

Tel.: +49 (0)40 - 88 90 100

www.toplicht.de

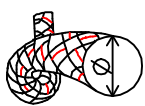

Ø 3 – 6mm
1/8" – 1/4"

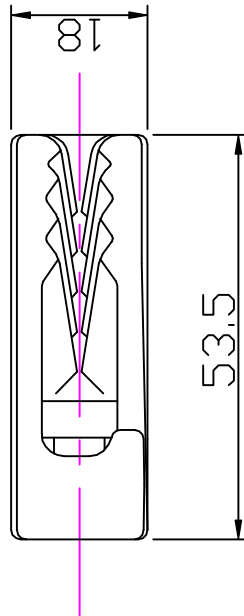
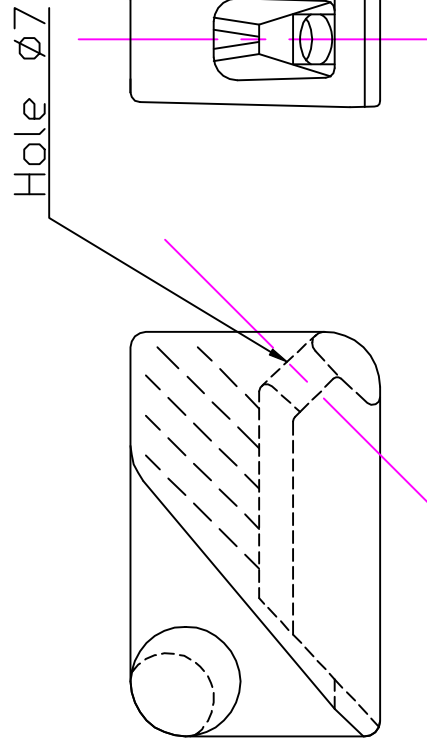
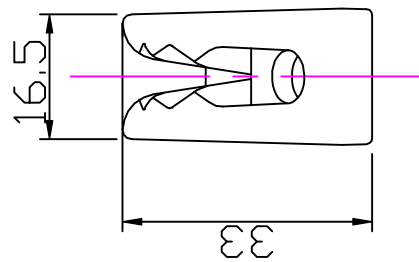
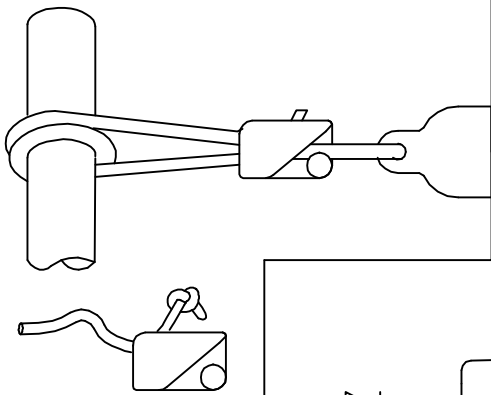
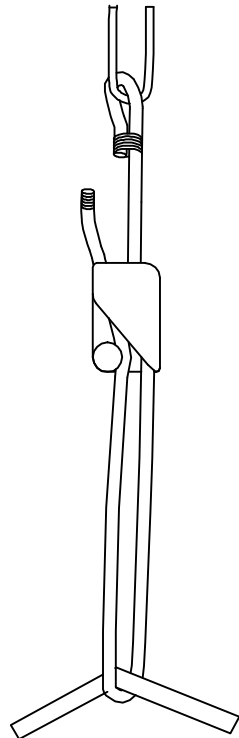
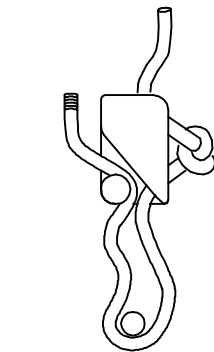

Clamcleat®
Rope cleats

Clamcleats Limited
Watchmead
Welwyn Garden City
Hertfordshire AL7 1AP
England

Telephone +44 (0)1707 330101
Fax +44 (0)1707 321269
<http://www.clamcleat-rope-cleats.com>



Scale 1:1

All dimensions in mm.

Issue: 1. Jun 2000
ID223.dwg

Material: Nylon

Installation Drawing for: –

CL223

Loop Cleat

Clamcleat®
Rope cleats

CL223 Loop cleat

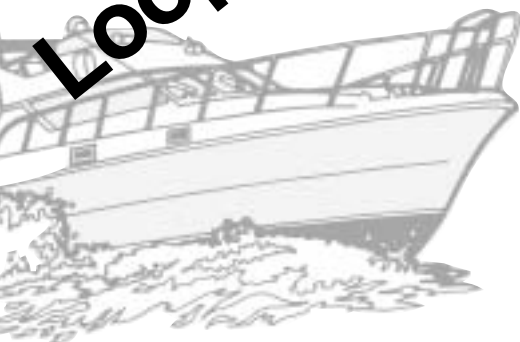

www.clamcleat.com

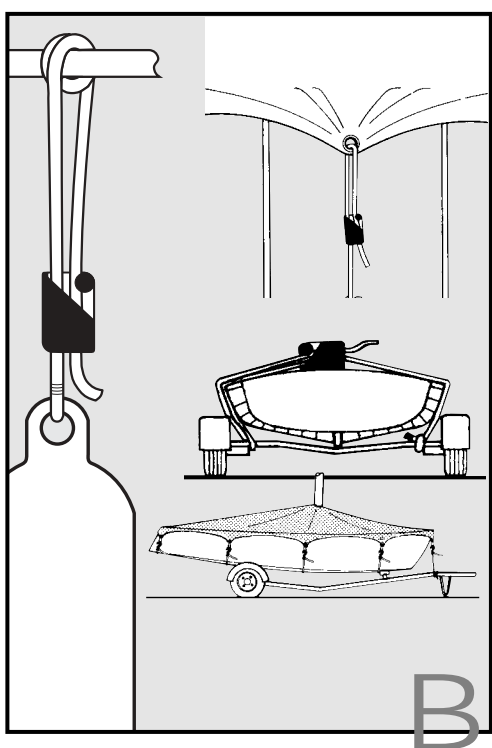
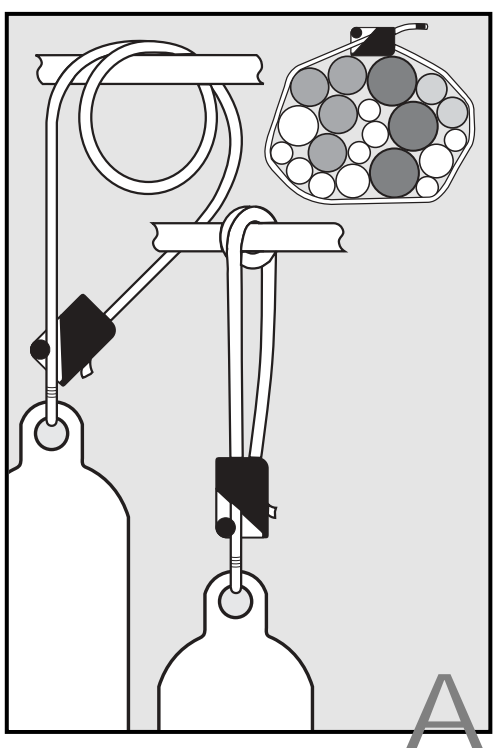
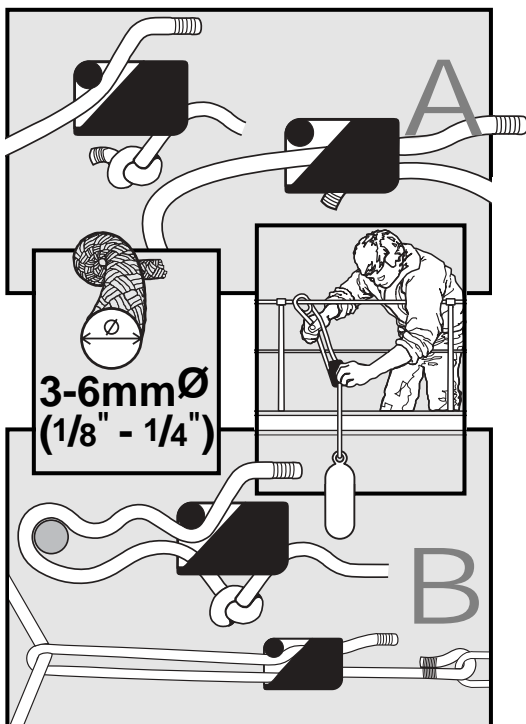

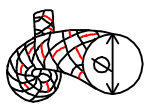

Ø6-12mm.
1/4"-7/16"

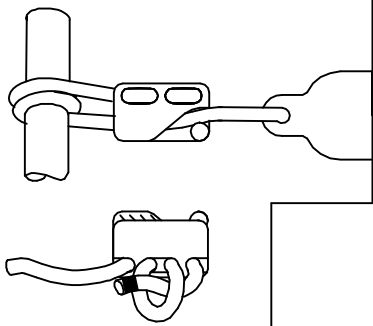
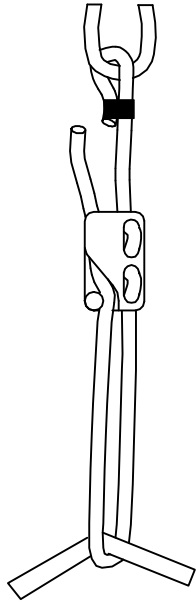
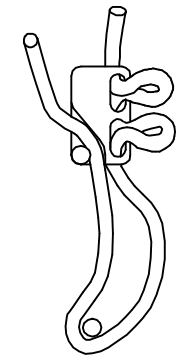

4 Holes Ø12

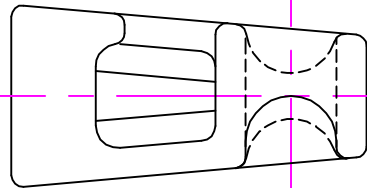
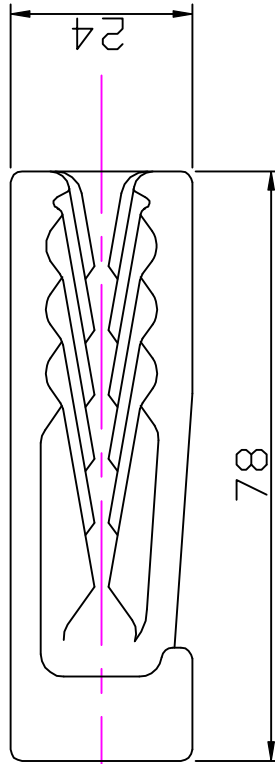
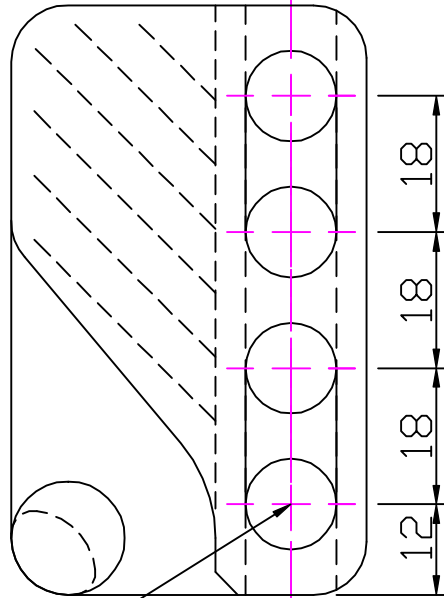
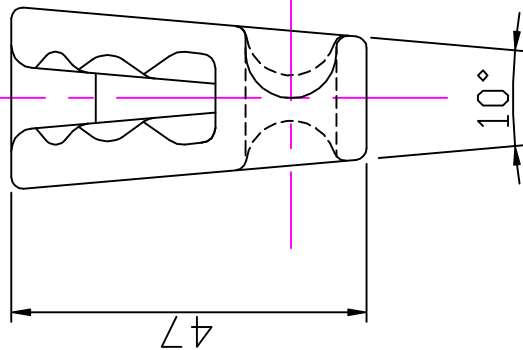

Clamcleat®
Rope cleats

Clamcleats Limited
Watchmead
Welwyn Garden City
Hertfordshire AL7 1AP
England

Telephone +44 (0)1707 330101
Fax +44 (0)1707 321269
<http://www.clamcleat-rope-cleats.com>

Scale 1:1

All dimensions in mm.



Issue: 1. Jun 2000
ID234.dwg

Material: Nylon

Installation Drawing for: -

CL234

Large Loop Cleat

Clamcleat®
Rope cleats

CL234
Large
Loop cleat

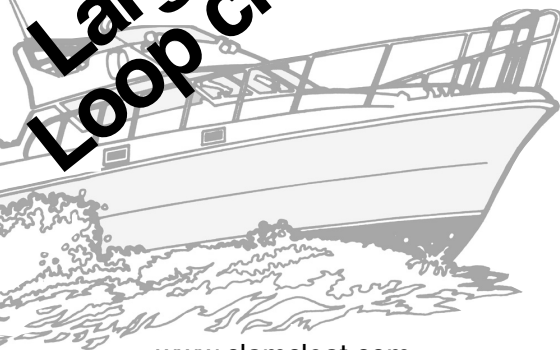
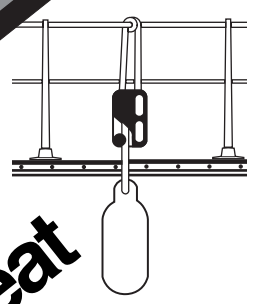

www.clamcleat.com

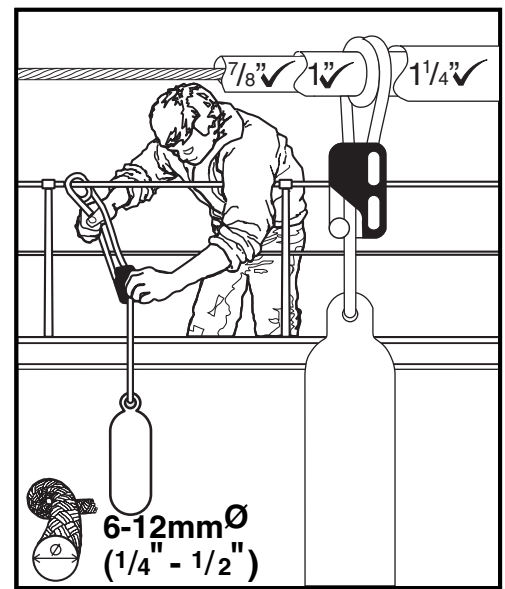

6-12mm \varnothing
(1/4" - 1/2")

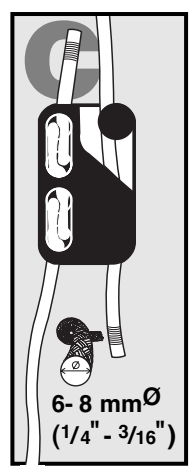
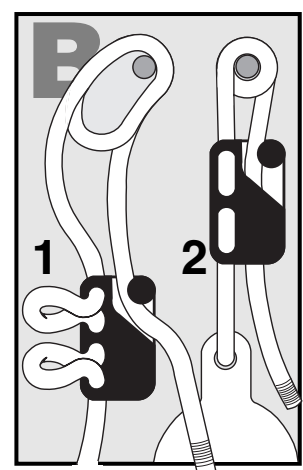
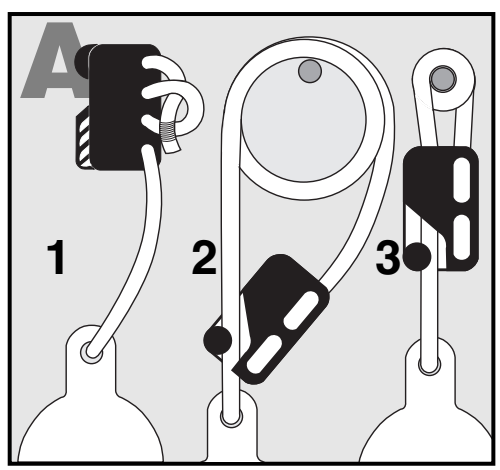
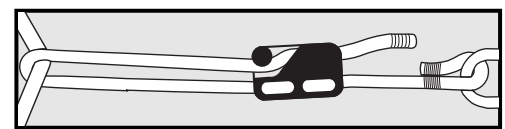

6 - 8 mm \varnothing
(1/4" - 3/16")

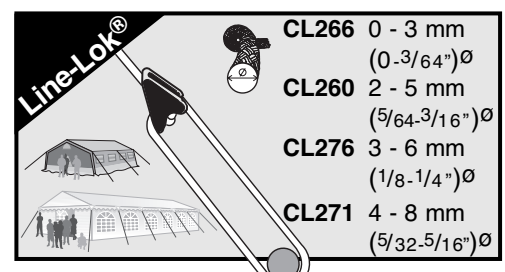
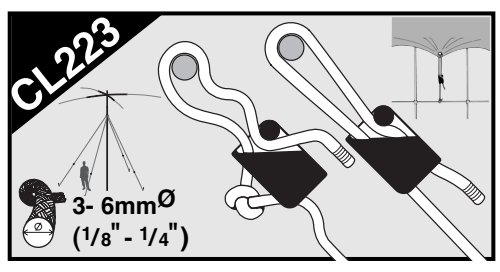

CL266 0 - 3 mm
(0.3/64") \varnothing
CL260 2 - 5 mm
(5/64-3/16") \varnothing
CL276 3 - 6 mm
(1/8-1/4") \varnothing
CL271 4 - 8 mm
(5/32-5/16") \varnothing